

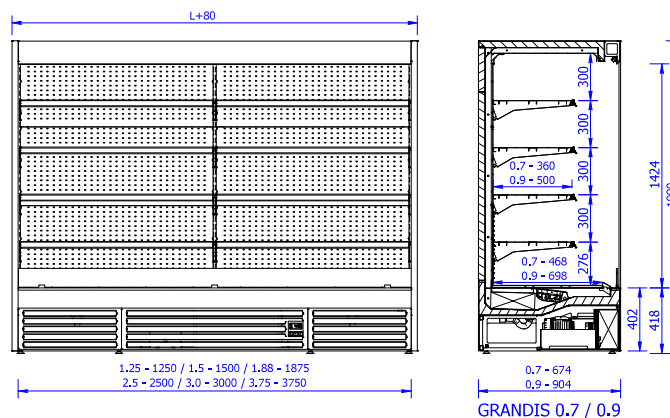

www.mawi-poland.pl



GLASS SIDE VERSION



+1 ... +10 °C

MODEL	DIMENSIONS (L x D x H) [mm]	LENGTH WITHOUT SIDES [mm]	AMBIENT CONDITIONS [C/RH]	REFRIGERANT	THE AREA OF COOLING SURFACE [m ²]
GRANDIS 1.25 - 0.7 / 0.9	1330 x 674 / 904 x 1990	1250	+15 ... +25 / 60%	R290	2.39 / 3.37
GRANDIS 1.5 - 0.7 / 0.9	1580 x 674 / 904 x 1990	1500	+15 ... +25 / 60%	R290	2.86 / 4.05
GRANDIS 1.88 - 0.7 / 0.9	1955 x 674 / 904 x 1990	1875	+15 ... +25 / 60%	R290	3.58 / 5.06
GRANDIS 2.5 - 0.7 / 0.9	2580 x 674 / 904 x 1990	2500	+15 ... +25 / 60%	R290	4.77 / 6.75
GRANDIS 3.0 - 0.7 / 0.9	3080 x 674 / 904 x 1990	3000	+15 ... +25 / 60%	R290	5.72 / 8.09
GRANDIS 3.75 - 0.7 / 0.9	3830 x 674 / 904 x 1990	3750	+15 ... +25 / 60%	R290	7.16 / 10.12

GRANDIS 0.7 / 0.9

STANDARD EQUIPMENT

- Open version - without doors
- Night roller blind
- Internal cooling aggregate - plug in version
- Refrigerant R290
- Energy-saving fans on evaporator
- Dynamic cooling
- Electronic thermostat with digital display
- Four rows of shelves with price strip painted in white with an option of adjustment of height and angle
- Top LED lighting
- Steel insulated sides - external painting, the choice of colour from Mawi RAL, internal made of polished stainless steel - mirror effect
- Base and front cover, the option of choosing a colour from the available Mawi RAL
- Automatic defrost

AVAILABLE OPTIONS

OPTIONS	UNIT
Connection of devices	set
Strengthening of full shelves	set
Condensate electric evaporator	set
Additional painted shelf with brackets and price strips	1m
Led lighting (warm color) under the one shelf	1m
Led lighting in the angular profile on the sides of the rack	set
All shelves (hanging + bottom) made of h17 stainless steel	1m
All shelves (hanging + bottom) made of h18 acid-resistant steel	1m
All elements of the interior of the h17 stainless steel rack (shelves, brackets, back, bottom)	1m
All elements of the interior made of acid-resistant h18 steel shelves (shelves, supports, back, bottom)	1m
Additional shelf made of h17 stainless steel	1m
Additional shelf made of acid-resistant h18 sheet	1m
Stainless steel hook bar with 6 "s" hooks per mb (instead of one shelf)	1m
Hook bar made of stainless steel with 6 welded hooks per meter (instead of 1 shelf)	1m
Painting the evaporator	1m
Electric evaporator - automatic evaporation of condensate	set
Condensate pump with a container	set
Painting the entire interior of the bookcase according to Mawi RAL	set
Upper suspended mirror	1m